

CS1000 Alarm System

Easy-to-Install Indoor Alarm System

This alarm system monitors liquid levels in lift pump chambers, sump pump basins, holding tanks, sewage, agricultural, and other water applications.

The **CS1000** alarm system can serve as a high or low level alarm depending on the float switch model used.

The alarm horn sounds when a potentially threatening liquid level condition occurs. The horn can be silenced, but the red warning light remains on until the condition is remedied. A green "power on" light indicates power to the alarm panel.

FEATURES

- NEMA 1 enclosure, designed for ease of installation, rated for indoor use
- Red "alarm" light, green "power on" light, alarm "test" switch, and horn "silence" switch
- Alarm horn sounds at 86 decibels at 10 feet (3 meters)
- Can be use with any UL Listed / Recognized switching mechanism rated to include 1 amp, 12 VAC load
- Alarm system (when installed on separate circuit) operates even if the pump circuit fails
- Complete package includes Control Duty Narrow Angle Mechanical control switch with 15 feet of cable
- Switching mechanism operates on low voltage and is isolated from power line to reduce possibility of shock
- Alternate float switch models for high or low level warning
- 230V models available

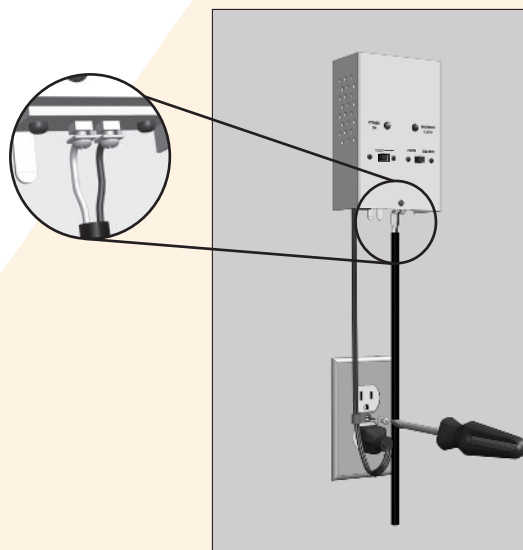

CSI Controls®

Toll Free: 888-342-5753
customer.service@sjeinc.com
www.csicontrols.com

CS1000 ALARM - 115 VAC

Part #	Description	Shipping Weight
1023236	CS1000, NEMA 1 Indoor Alarm with Manual Reset Feature	3.58 lbs.
1035488	CS1000-NF, No Float	2.14 lbs.
1051051	CS1200-SPKT, includes Splice Kit	3.58 lbs.

MASTER CARTON holds 16 boxed units.
SEE PRICE BOOK FOR LIST PRICE.

SPECIFICATIONS

VOLTAGE FOR 115 VAC MODEL:

Primary: 115 VAC, 50/60 Hz, 5 watts max. (alarm condition)

Secondary: 12 VAC

ALARM ENCLOSURE: 6 x 4 x 2.5 inches (15.24 x 10.16 x 6.35 cm), NEMA 1 metal

ALARM HORN: 86 decibels at 10 feet (3 meters)

POWER CORD: 6 feet (1.8 meters)

FLOAT SWITCH CONNECTION TERMINAL: for float switch connection only. Do not apply power.
Voltage across terminals is 12 VAC

FLOAT SWITCH: **Control Duty Narrow Angle Mechanical** control switch with mounting clamp

CABLE: 15 feet (4.57 meters), flexible 18 gauge, 2 conductor (UL) SJOW, water-resistant (CPE)

FLOAT: 2.74 inch diameter x 4.83 inch long (7 cm x 12.3 cm), high impact, corrosion resistant polypropylene housing for use in sewage and non-potable water up to 140°F (60°C)

MAXIMUM WATER DEPTH: 30 feet (9 meters), 13 psi

ELECTRICAL: 5 amps, 125 VAC/250 VAC, 50/60 Hz

OPTIONS

CONTROL SWITCH OPTIONS

The **CS1000** alarm system comes standard with a 15 foot **Control Duty Narrow Angle Mechanical** control switch with mounting clamp. Other float switches are available. See control switch section of the catalog.

To determine the price of alarm with an alternate float, add the price of the part number with "no float" to the price of the float switch.



Toll Free: 888-342-5753
customer.service@sjeinc.com
www.csicontrols.com